

700 SHT.1
BEAUFORT WEST

C.D.R.

T.P.

SHEET 1.
THIS PLAN COMPRISES 3 SHEETS

GENERAL PLAN 700 LD

The Figure A.B.C.D.E.F.G.H.I.J.K.L.M.N.O.P.Q.R.S.T.U.V.W.X.Y.Z.A.B.C.D.E.F. represents the Turning of

BEAUFORT WEST (EXTENSION N° 2)

S.G. N° 1510 / 48

② ②

In extent: 62-834 Meters comprising 31 urban numbered 1031 - 1022, the Streets and a Lane, being Consolidated

of N° 23, Beaufort West, Situate in the Municipality and Division of Beaufort West, Province of Cape Good Hope

Vol. Diagram S.G. N° 1510/48 annexed to Certificate of Registration No. 2605/48 of 24-12-1948

C.D.R.

Approved

The bearings of each erf represented on this plan are in accordance with regulation and have been placed under my supervision.

Surveyed in October 1947 by me

and Surveyor

Area of Plot Area.

ERF	Area of Plot	Area of Section	System of Measurement
48	844.35	254.3	A
49	80.50	244.3	A
50	55.44	171.43	A
51	855.01	311.52	A
52	85.58	237.43	A
53	452.02	731.52	A
54	44.35	127.43	A
55	1987.00	731.52	A
56	65.00	41.53	A
57	28.49	80.5	A
58	1074.31	23.54	A
59	531.86	80.5	A
60	485.47	170.45	A
61	52.24	152.45	A
62	124.85	174.3	A
63	400.00	80.5	A
64	100.00	174.3	A
65	125.42	80.5	A
66	541.38	133.0	A
67	62.88	115.1	A
68	41.60	43.00	A
69	57.44	125.37	A
70	880.61	175.00	A
71	105.48	105.47	A
72	100.00	84.4	A
73	10.57	30.5	A
74	190.00	84.4	A
75	10.00	30.5	A
76	10.00	30.5	A
77	10.00	30.5	A
78	10.00	30.5	A
79	10.00	30.5	A
80	10.00	30.5	A

Coordinates of Reference Marks

Coordinates	1° 23'	2° 23'
1031	1031.00	1031.00
1032	1032.00	1032.00
1033	1033.00	1033.00
1034	1034.00	1034.00
1035	1035.00	1035.00
1036	1036.00	1036.00
1037	1037.00	1037.00
1038	1038.00	1038.00
1039	1039.00	1039.00
1040	1040.00	1040.00
1041	1041.00	1041.00
1042	1042.00	1042.00
1043	1043.00	1043.00
1044	1044.00	1044.00
1045	1045.00	1045.00
1046	1046.00	1046.00
1047	1047.00	1047.00
1048	1048.00	1048.00
1049	1049.00	1049.00
1050	1050.00	1050.00
1051	1051.00	1051.00
1052	1052.00	1052.00
1053	1053.00	1053.00
1054	1054.00	1054.00
1055	1055.00	1055.00
1056	1056.00	1056.00
1057	1057.00	1057.00
1058	1058.00	1058.00
1059	1059.00	1059.00
1060	1060.00	1060.00
1061	1061.00	1061.00
1062	1062.00	1062.00
1063	1063.00	1063.00
1064	1064.00	1064.00
1065	1065.00	1065.00
1066	1066.00	1066.00
1067	1067.00	1067.00
1068	1068.00	1068.00
1069	1069.00	1069.00
1070	1070.00	1070.00

Coordinates of Block Corners

Coordinates	1° 23'	2° 23'
1031	1031.00	1031.00
1032	1032.00	1032.00
1033	1033.00	1033.00
1034	1034.00	1034.00
1035	1035.00	1035.00
1036	1036.00	1036.00
1037	1037.00	1037.00
1038	1038.00	1038.00
1039	1039.00	1039.00
1040	1040.00	1040.00
1041	1041.00	1041.00
1042	1042.00	1042.00
1043	1043.00	1043.00
1044	1044.00	1044.00
1045	1045.00	1045.00
1046	1046.00	1046.00
1047	1047.00	1047.00
1048	1048.00	1048.00
1049	1049.00	1049.00
1050	1050.00	1050.00
1051	1051.00	1051.00
1052	1052.00	1052.00
1053	1053.00	1053.00
1054	1054.00	1054.00
1055	1055.00	1055.00
1056	1056.00	1056.00
1057	1057.00	1057.00
1058	1058.00	1058.00
1059	1059.00	1059.00
1060	1060.00	1060.00
1061	1061.00	1061.00
1062	1062.00	1062.00
1063	1063.00	1063.00
1064	1064.00	1064.00
1065	1065.00	1065.00
1066	1066.00	1066.00
1067	1067.00	1067.00
1068	1068.00	1068.00
1069	1069.00	1069.00
1070	1070.00	1070.00

Interruption of Bearings

Reference Marks R.H.3. and R.H.5.

R.H.2. is also interruption point

Reference marks are sunk on page in concrete

D is sunk 5' x 12' post 6' vertical check-out on north face

1055 is a wooden corner pole in concrete

All other bearings are iron pole stations

Original Diagram N° 1510/48

S.G. File N° 4810/53

Survey Records N° E. 34/1048, E.

Compilation N°

m

Survey 1947

Page 2 of 2

Beaufort West

BEAUFORT WEST 700

SHT. 2

C.D.R.

SHEET 2

THIS PLAN COMPRISES 3 SHEETS.

T.P.

BEAUFORT WEST EXTENSION N°2 GENERAL PLAN 700^{LD}

C.D.R.

SG No 1510/48

Approved.

W. C. J. J. J.
Surveyor General
10.10.1948

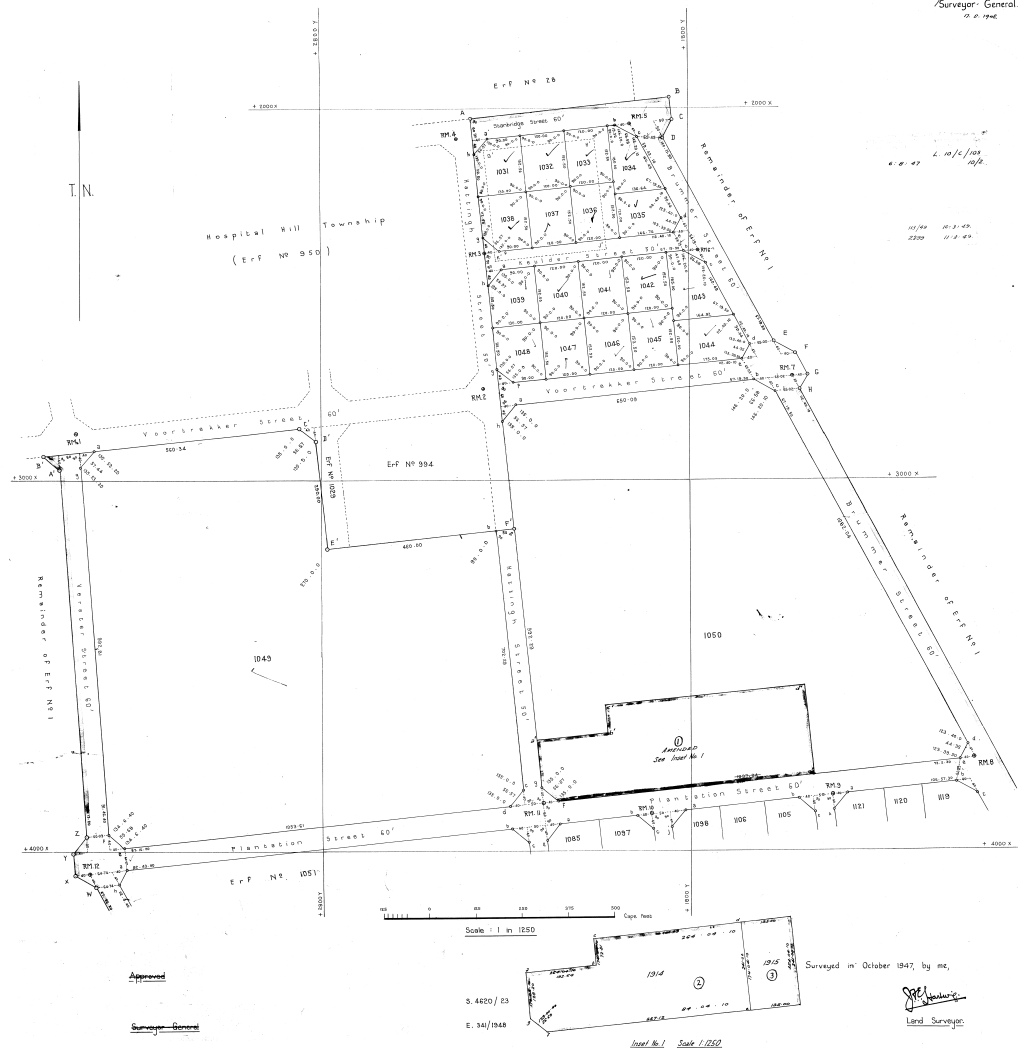

m

Beaufort West

10/10/48

SHOULD BE KEPT IN FILE

BEAUFORT WEST GENERAL PLAN 700^{LD}

S.G. No. 1519/48

Approved

W. C. G. G. G.
Surveyor General
11. 11. 1948

700 SHT. 3 C.D.R.

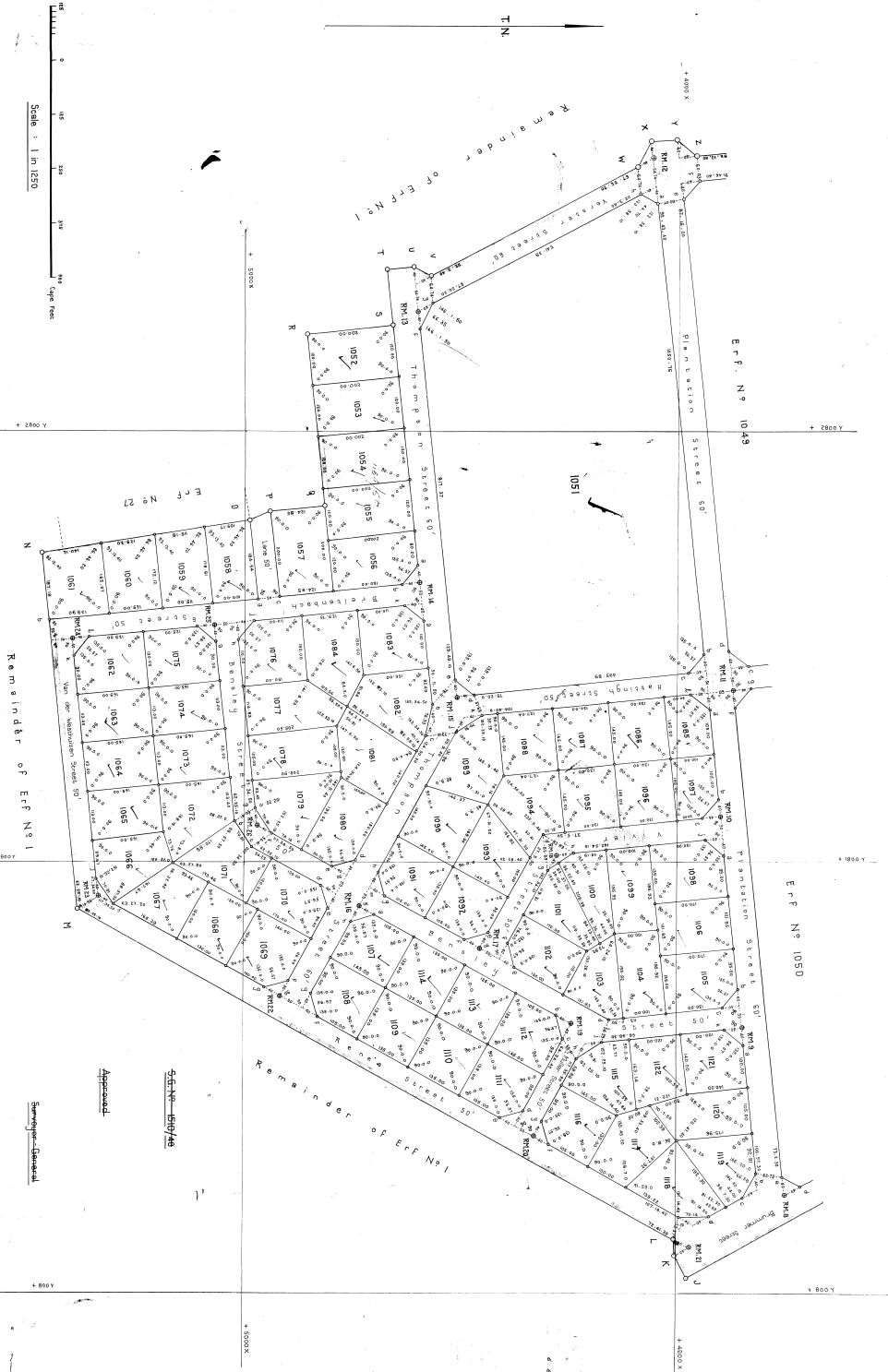

Surveyed in October 1947 by me,

W. C. G. G. G.
Surveyor

Surveyor-General

Approved

S.G. No. 1519/48

S. 4620/23

E. 34/1948



OFFICE COPY

SUB-DIVISIONAL DIAGRAM,
Sect. 24 (b), Act No. 9 of 1927.

General Plan TP 700

SIDES Cape Feet		ANGLES	
AB	57.44	A	135.53.20
BC	560.34	B	135.53.20
CD	56.57	C	135.0.0
DE	290.00	D	135.0.0
EF	460.00	E	270.0.0
FG	702.29	F	90.0.0
GH	56.57	G	135.0.0
HJ	1053.61	H	135.0.0
JK	55.66	J	134.6.40
KA	992.81	K	134.6.40

No. 1529/48

Approved

L. M. F. J.
Surveyor-General.
18 NOV 1948

Description of Beacons.

A.B.C.D.E.F.G.H.J.K — Iron pole sections

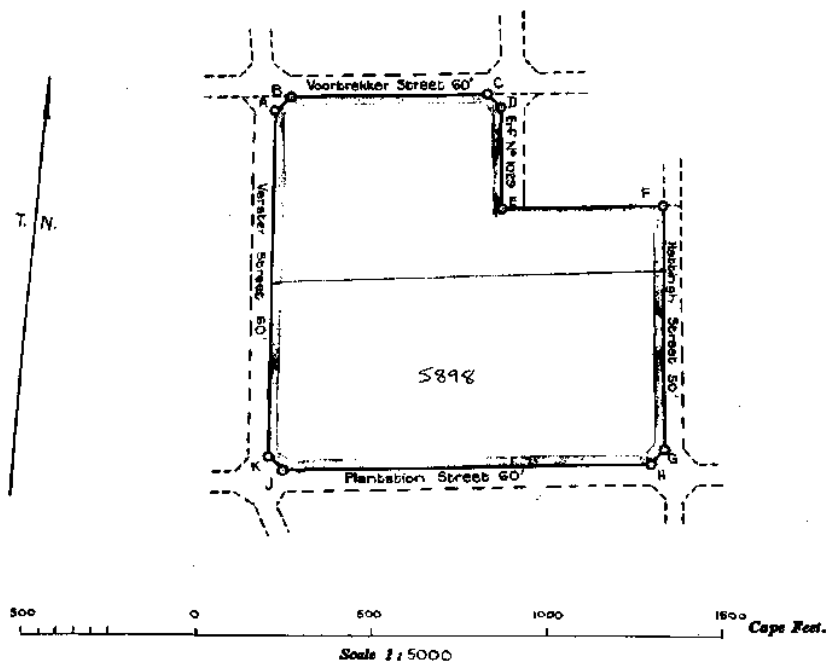

The figure A.B.C.D.E.F.G.H.J.K.

represents 12 0685 Morgen Square Feet of land being
ErF N° 1049, Beaufort West.

situate in the Municipality and

Division of Beaufort West

Province of Cape of Good Hope

Surveyed in October, 1947 by me

J. J. Harburg
Land Surveyor.

This diagram is annexed to Deed of Transfer in favour of the Educational Trustees for School District of Beaufort West.

The original diagram is No. annexed to

File No. 4626/23
S.R. No. E. 341/1948
General Plan TP 700
Schedule N° 1.

CL 4 AC (2353)
(2355)

B & B.P.G.T.

FOR ENDORSEMENTS
SEE BACK OF DIAGRAM

6605

15 OCT 1948

J. J. Harburg
Registrar of Deeds.

1045

THE FOLLOWING DEDUCTIONS HAVE BEEN MADE FROM THIS DIAGRAM						
SURVEY RECORD	DIAGRAM NO.	SUBDIVISION	AREA HA./SQ. M.	TRANSFER NO.	INITIALED	REMARKS
E 389/94	1052/94	Lot 5818				